

INJECTOR LOADING (To ensure correct loading of the lens into the injector, use magnification)

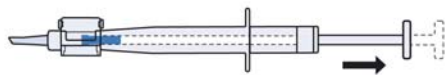

Step 1

Aseptically transfer the injector to the sterile field by tipping it from the tray. Fully retract the plunger ensuring that the blue tip does not protrude into the loading bay.

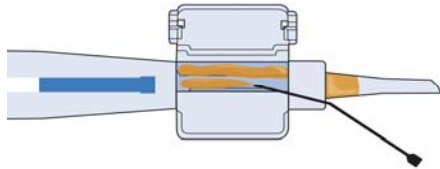

Step 2

Open the loading bay flap fully to 90° and sparingly apply a commercially available viscoelastic inside the nozzle and to both grooves of the loading bay. Balanced salt solution alone should not be used as a lubricant.

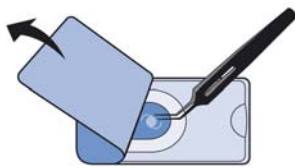

Step 3

Carefully peel back the foil lid of the lens blister. Gently lift out the lens using parallel-tipped, non-serrated forceps e.g. Kelman-McPherson. Rinse the IOL with sterile Balanced Salt Solution.

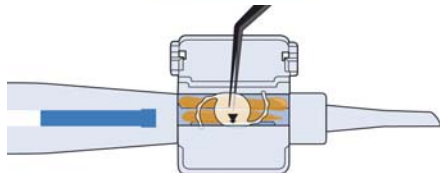

Step 4

Position the lens in the loading bay in a **“reverse - S” configuration**. Ensure that the nearest edge of the optic is securely under the edge (lip) of the barrel as shown.

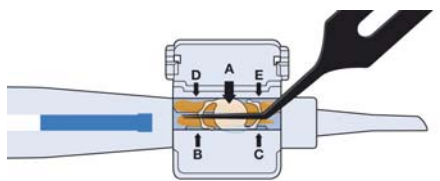

Step 5

Hold open the flap and press down on lens with closed forceps to ensure the furthest edge of the optic is securely under the edge (lip) of the flap as shown (A). **Fold the tips of both haptics towards the optic** and tuck under the edge (lip) of the barrel and edge (lip) of the flap as shown (B, C, D, and E). Ensure the haptics and optic are completely within the loading bay.

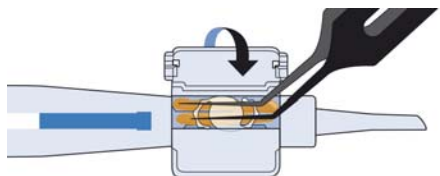

Step 6

While keeping the lens in position with open forceps, gently close the flaps of the injector **ensuring that no part of the optic or haptics is trapped**, before locking the flaps firmly together.

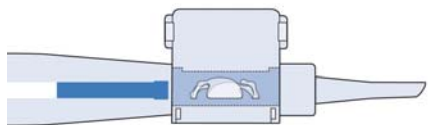

Step 7

Visually observe that the lens is symmetrically folded within the loading bay. Advance the plunger in a slow controlled manner. Anticipate an initial slight resistance. Excessive resistance could indicate a trapped lens.

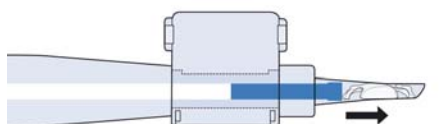

Step 8

Observe that the lens stays symmetrically folded within the nozzle. When the lens exits the nozzle, stop depressing the plunger. The plunger is only to be depressed once.

Tips to remember for achieving a successful implantation

1. This is a single use device, **never** attempt to re-use it.
2. **DO NOT** “test” the injector by depressing and retracting the plunger prior to loading the lens.
3. Always add viscoelastic to the loading bay and close fully before injection.
4. Ensure that prior to loading, the injector plunger is fully retracted.
5. Ensure that **NO** part of the lens is projecting outside the edges of the loading bay before closing flaps.
6. When closing and locking the injector flaps, any resistance could indicate a trapped lens.
7. When depressing the plunger too much resistance could indicate a trapped lens.
8. Before injecting, always ensure correct configuration within the nozzle.
9. Once the lens is expressed, do not retract the plunger.

Note: If the IOL causes a blockage in the injector system, discard the injector. Discard the injector after use.